

**WORK AUTHORIZATION # CM1414-WA09
 NASSAU COUNTY
 BOARD OF COUNTY COMMISSIONERS
 RFQ/BID NO. NC08-015**

Consultant:	PBS&J
Contract Number:	CM1414
Contact Name:	Michael Holcomb, Office Leader/Associate Vice President
Contact Number:	904-363-8460
Email:	meholcomb@pbsj.com

CURRENT WORK AUTHORIZATION	
Project Short Title: Design Services – CR 108 @ CR 115A	
Date Submitted	09/28/09
Amount	\$83,912.05
Scheduled Completion: Design/Final Const. plans within 120 calendar days of the NPT	

This Work Authorization is to the AGREEMENT between Nassau County and the Consultant known as the Continuing Contract for Professional Engineering Services for Nassau County, Florida, dated March 23, 2009. The services to be provided under this Work Authorization are as follows:

ARTICLE 1. Services Described as:

The intent of this project is to provide final construction documents and all required permits for the proposed roadway and associated turnlane improvements for the CR108 / CR115A reconstruction project. The Scope of Services and project is furthermore described in Exhibit A attached hereto and in the Transportation Impact Fee Study dated 10/07/09 prepared by King Engineering and provided to the Consultant.

ARTICLE 2. Time Schedule

All elements contained in this scope shall be satisfactorily completed and submitted to the County within 120 calendar days of the Notice to Proceed (NTP) from the County, excepting Bid Phase and Post Design services which shall be performed in a timely manner, as required and prior to billing for those services.

ARTICLE 3. Budget

Compensation for this work authorization is based upon a combination of lump sum task and task under a limiting amount (not to exceed) as provided in the Estimate of Work Effort and Fee, Attached as Exhibit B. Lump Sum Total for Task 1 – 12 is \$78,798.93; Limiting Amount for Task 13 is \$5,113.12; for a Total Project cost \$83,912.05.

Article 4. Other Provisions

The Services covered by this Work Authorization will be performed in accordance with the provisions set forth in the AGREEMENT referenced above and any of its attachments or schedules. This Work Authorization will become a part of the referenced AGREEMENT when executed by both parties.

In presenting this Work Authorization, Consultant agrees that:

Unless detailed herein, all drawings, data, electronic files and other information required for this Work Authorization has been accepted by Consultant. Specifically, all electronic files have been reviewed and accepted for the purposes of this Work assignment. Any additional information, including detailed scope of services is attached.

AGREED TO BY:

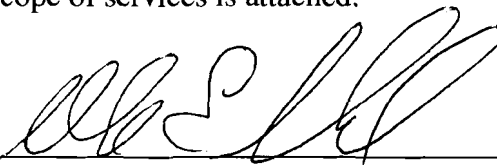
BY: 
Print Name: Michael E. Holcomb
Title: Associate Vice President
Date: 11/18/09

RECOMMENDED AND APPROVED BY NASSAU COUNTY:

Director of Engineering Services:
Vice Chair
Board of County Commissioners, Chair:

Michael H. Boyle

Ex-Officio Clerk:

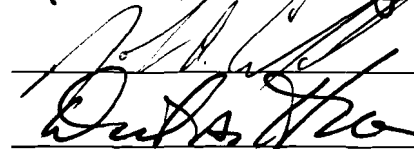
EAK
12/19/09

County Attorney:

APPROVED by the BOARD OF COUNTY COMMISSIONERS, the 9th day of December, 2009

EXHIBIT A
SCOPE OF SERVICES
ENGINEERING SERVICES
FOR
CR108 @ CR115A

NASSAU COUNTY, FLORIDA

October 9, 2009

A. PROJECT DESCRIPTION

1. The Intent of this project is to provide final construction documents and all required permits for the proposed roadway and associated turnlane improvements for the CR108 / CR115A reconstruction project. The project is furthermore described in the Transportation Impact Fee Study dated 10/07/2009 prepared by King Engineering and provided to the Consultant.
2. The project limits extend approximately 205' feet north on CR115A and 205' feet east and 155' west on CR108. Note that these dimensions are based on the proposed condition.
3. The scope of this project is based on recommendations from the study referenced in paragraph 1. These improvements include the following:
 - a. Reconstruct the intersection from a "Y" into a "T" configuration.
 - b. Construct a westbound left turn lane on CR108 Street onto northbound CR115A.
 - c. Construct an eastbound right turn lane on CR108 onto northbound CR115A.
 - d. Construct eastbound and westbound turn lanes on CR115A onto CR115A.

B. PROJECT SCOPE

1. Data Collection

- a. **Geotechnical** - Four (4) Pavement cores and six foot deep auger borings will be performed. Laboratory classification testing, index property testing and LBR tests will then be performed on samples obtained from the borings to help classify the soils and allow correlations with various engineering properties. An engineering report will be prepared that will include a review of available project information, a discussion and results of the conducted field and laboratory services, a discussion of site and subsurface conditions, recommendations for pavement milling depth, and resurfacing and recommendations for remediation of any distressed pavement.
- b. **Survey / Right -of-Way Mapping** – The consultant shall provide survey services within the projects limits as follows:
 - a. Establish Horizontal and Vertical Control.
 - b. Establish Baseline of survey.
 - c. Establish project Benchmarks.
 - d. Locate existing right-of-way lines.
 - e. Design Survey within project limits, right-of-way line to right-of-way line, including all above ground features together with drainage structures.
 - f. Survey sub-surface (underground) utilities within project limits.
 - g. Provide survey data by electronic files.
- c. **Traffic Data** - Traffic data from the Transportation Impact Fee Study will be utilized for the design of his project and thus no additional data will be necessary.

2. Project General Tasks

- a. **Notice to Proceed Meeting** - The Consultant team shall prepare for and attend one Notice to Proceed Meeting with Nassau County staff.
- b. **Project Status Meetings** - The appropriate members of the Consulting team shall attend up to three monthly progress meetings with the County staff to discuss project progress and status, upcoming events and activities. The purpose of these meetings is to maintain clear communication between the County and the Project Team. The

Consultant shall prepare and distribute meeting minutes following each of these meetings.

- c. **Other Coordination Meetings** - The appropriate members of the Consulting team shall attend other additional meetings with adjacent agencies and/or their consultants as appropriate.
- d. **Project Schedule** - The Consultant shall prepare and submit a project schedule for this project identifying major tasks, their duration and tasks relationships. The schedule shall be updated monthly and at other appropriate intervals.
- e. **Invoices/Progress Report** - Invoices shall be prepared in the format prescribed by the County. Progress reports shall be submitted with each monthly invoice.
- f. **Quality Assurance/Quality Control** - The Consultant shall designate appropriate staff to conduct Quality Assurance/Quality Control (QA/QC) reviews of all work products prior to submittals to the County.

3. Roadway Analysis and Plans

The Consultant will perform the necessary roadway analyses and prepare construction plan sheets, notes and details for a complete set of roadway construction documents to convey the intent and scope of the project for the purposes of construction. The consultant will develop a pavement design based on the existing traffic data provided by the County and pavement cores obtained as part of this scope. Included herein are also the analyses, plans and design details necessary for a safe and effective Maintenance of Traffic (MOT) Plan to move vehicular traffic during all phases of construction. The design will be prepared in accordance with the FDOT Green Book, County Standards and the FDOT Design Standards for Design, Construction, Maintenance and Utility Operations on the State Highway System (Topic No. 625-010-003), latest editions, as applicable. This task will also include the preparation of Standard Specifications and Special Provisions.

4. Drainage Analysis

The Consultant will provide final drainage design services necessary to design roadside ditches that will support the proposed roadway improvements. The consultant's drainage analysis includes the following provisions:

- a. The Consultant will be responsible for the preparation of final design analyses for a complete drainage system. All design work will be in compliance with the FDOT Drainage Manual, County Standards, and the requirements of the regulatory agencies. This work includes the design of roadside ditches and cross drain culverts as required.
- b. The Consultant will meet with the SJRWMD to verify the assumption that since this project is classified as a safety improvement, no permit and associated stormwater treatment facilities will be required and thus are not included herein.
- c. The Consultant will account for all off-site drainage currently flowing to the roadway and accommodate for same in the design.
- d. The Consultant will provide a signed and sealed Drainage Design Report. It will be a record set of all drainage computations, both hydrologic and hydraulic.

5. Utility Coordination

The Consultant shall be responsible for coordinating all design with the affected utility companies in order to minimize utility conflicts. The following services will be included:

- a. **Utility Coordination** – The Consultant shall coordinate with the known private and public utility companies within the project corridor and obtain plans of their existing facilities within the project limits. The consultant shall re-contact these utilities and submit 60% design plans that include all known existing utilities. The consultant shall make a final contact with these utilities to submit 90% plans that show all existing and proposed utility relocations.
- b. **Subsurface Utility Exploration** – A visual inspection has been made along the anticipated project construction limits. There is no evidence of underground utilities, thus no SUE's are anticipated nor included in this scope of work.

6. Signing and Pavement Marking Analyses and Plans

The Consultant will perform the necessary signing and pavement marking analyses and prepare construction plan sheets, notes and details for a complete set of signing and pavement marking documents to convey the intent and scope of the project for the purposes of construction.

7. Signalization Analyses and Plans

N/A as none are anticipated.

8. Permitting

The Consultant will be responsible for obtaining the following permits:

- a. The CONSULTANT shall provide the information necessary to submit the application for a National Pollutant Discharge Elimination System (NPDES) General Permit within 60 days of NTP.
- b. St. Johns River Water Management District
 - i. Attend and facilitate a pre-design meeting within 30 days of NTP.
 - ii. The consultant shall submit for a formal exemption from the stormwater permitting requirements of St. Johns River Water Management District under Chapter 40C-42.0225 (5)(c) F.A.C. within 60 days of NTP.
 - iii. Based on conversations with the County, no jurisdictional wetland mitigation or other such permitting issues are anticipated for this project. Should any such ecological science services be required of the Consultant, they will be included in addition to this scope and fee.
 - iv. The consultant shall be responsible for responding to any requests for additional information regarding the above permit submittal

9. Roadway Lighting Analyses and Plans

Not included herein.

10. Landscape Analyses and Plans

Not included herein

11. Right of Way Mapping

Not included herein except as previously described.

12. Construction Cost Estimate

To be provided at 60% and final plan stages.

13. Bid Phase Services

The Consultant will prepare a bid package including front end documents, special provision and specification for the bidding of this project. The consultant will also formally respond to questions during the bidding phase of the project and prepare a recommendation of the lowest qualified bidder based on the county prepared bid tabulations.

14. Post Design Services

The Consultant will provide post design services to include shop drawing review and approval, response to contractor RAI's, as-built review and certification and filing of a NOT upon completion of the project.

C. PROJECT DELIVERABLES

The Consultant shall contact the County prior to making a submission to verify the number of copies to submit. Up to Five draft copies of the construction and required supporting documents (reports, design calculations, letters, memos, etc.) will be submitted at the 60%, 90% and final stages of design.

D. PROJECT SCHEDULE

All elements contained in this scope shall be satisfactorily completed and submitted to the County within 120 calendar days of the NTP from the County, excepting Bid Phase and Post Design services which shall be performed in a timely manner, as required and prior to billing for those services.

E. COMPENSATION

Consultant will perform the scope of services outlined herein for a lump sum fee of \$XX.XXX.

F. COUNTY RESPONSIBILITIES

- a. Documents- The County shall provide access to any available plans, maps and other pertinent information under its control essential to the satisfactory completion of the work indicated herein.
- b. Reviews- The County will provide timely reviews of The Consultant's work in accordance with the schedule agreed upon between the County and The Consultant. Each review period by the county shall be two weeks, at which time all comments will be forwarded to The Consultant.

G.ASSUMPTIONS

- a. This effort included in this scope is not intended to meet the FDOT or the Federal NEPA process.
- b. This effort does not include any Contamination investigations or analysis. If areas are identified during the design phase requiring further analysis, they will be addressed separately.
- c. Utility relocation design services are not included in this scope of work. If relocations and/or upgrades are identified as necessary by utility agencies, the relocation design work will be addressed separately.
- d. Wetland mitigation and/or threatened and endangered species mitigation efforts and/or designs are not included with this scope. If necessary, efforts will be addressed separately.
- e. The County will be responsible for all agency permitting and/or application fees. These costs are not part of The Consultant's scope and proposal.

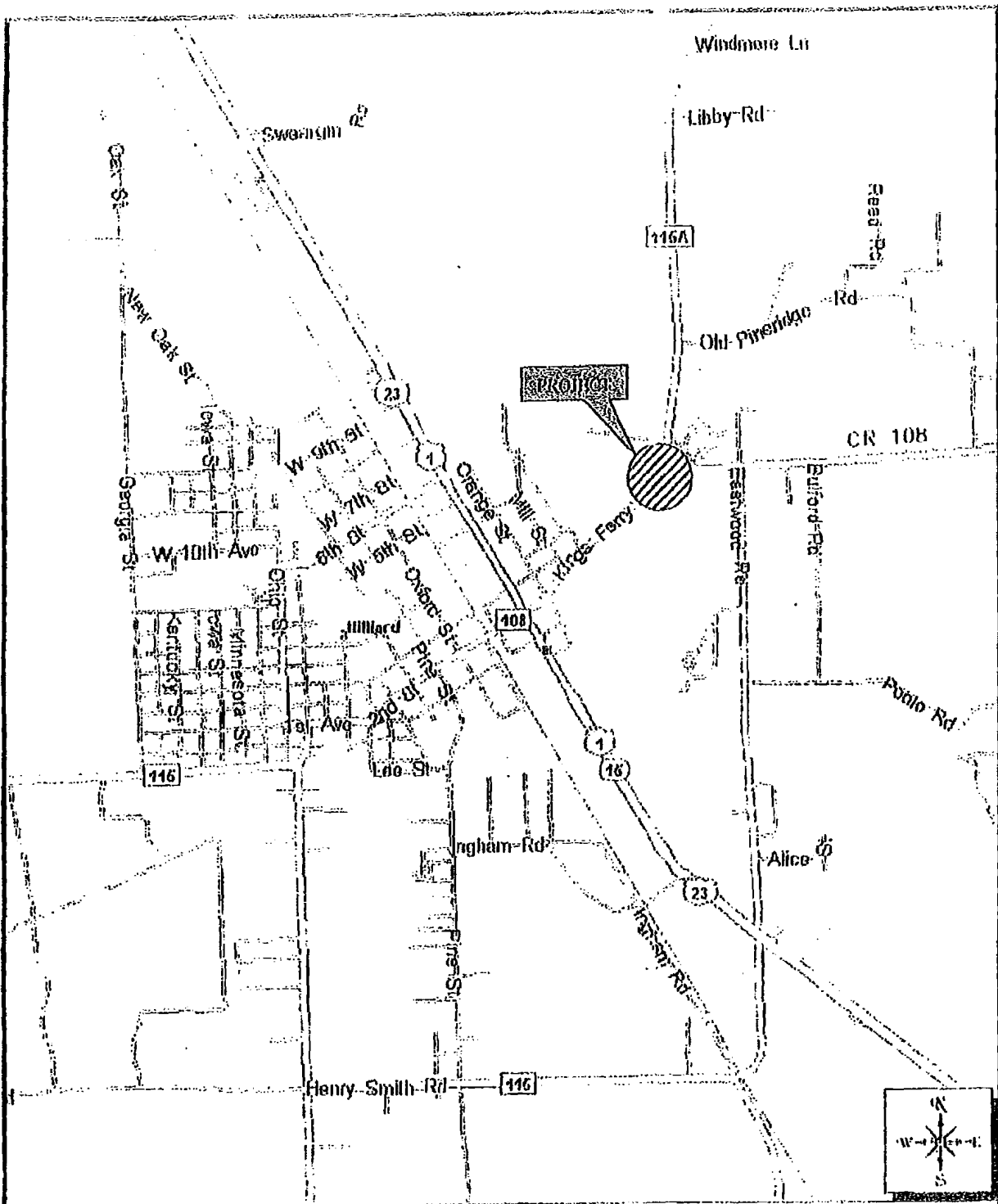

PROJECT LOCATION MAP

King
 PROJECTS ASSOCIATES, INC.
 6500 Rowlett Road
 Suite 200
 Jacksonville, FL 32216
 Phone: 904 636-6255
 Fax: 904 636-9333

CR 108 AT CR 115A
 NASSAU COUNTY IMPACT FEE STUDY
 NASSAU COUNTY, FLORIDA

Figure
 1

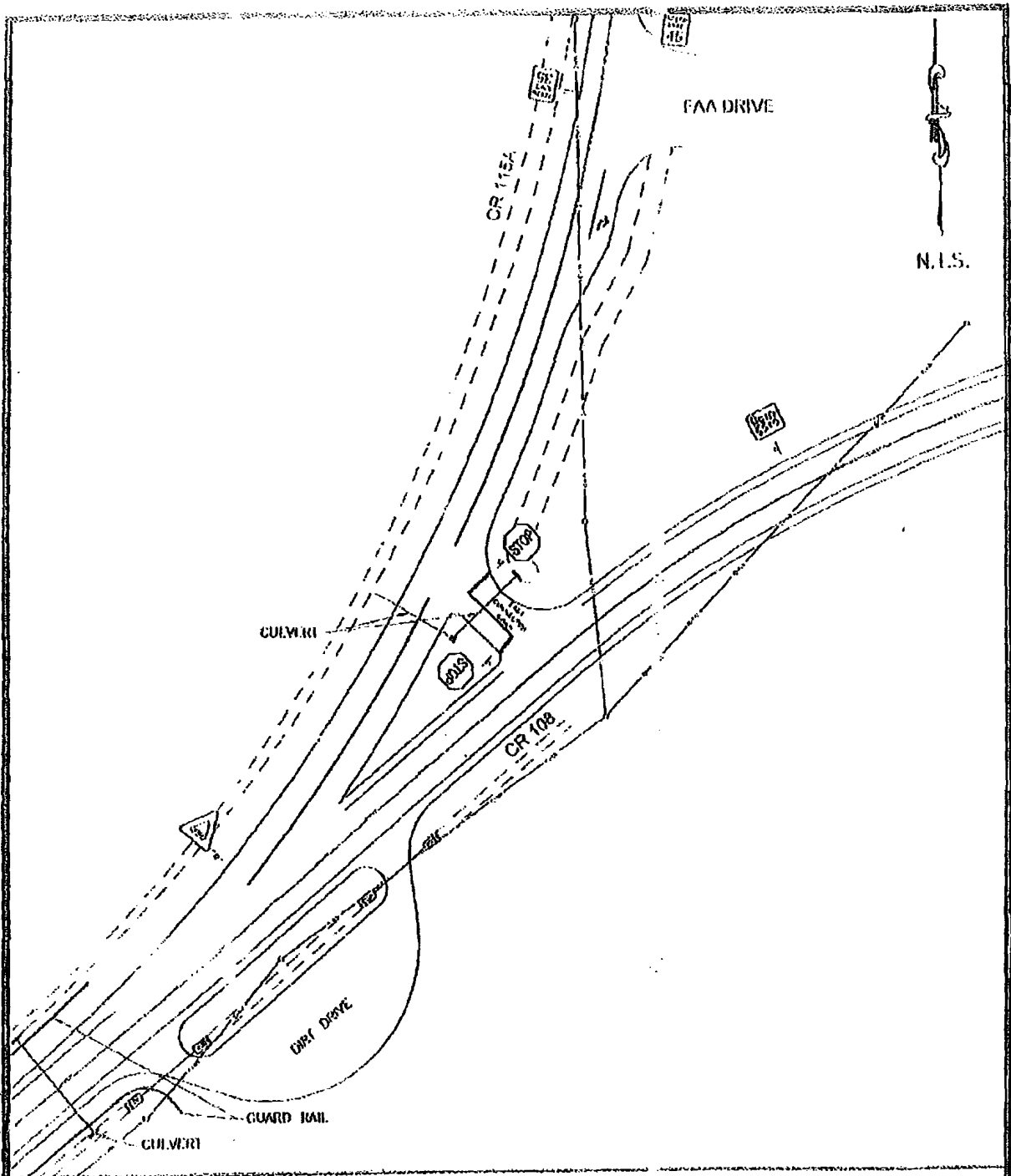

EXISTING CONDITIONS

King
 ENGINEERS, INC.

6510 Boardwalk Blvd. Ste. 200
 Jacksonville, FL 32216
 Phone: 904.261.6776
 Fax: 904.416.5534
 www.KingEngineers.com
 License No. 12000-2700

CR 108 AT CR 115A
 NASSAU COUNTY IMPACT FEE STUDY
 NASSAU COUNTY, FLORIDA

Figure
 2

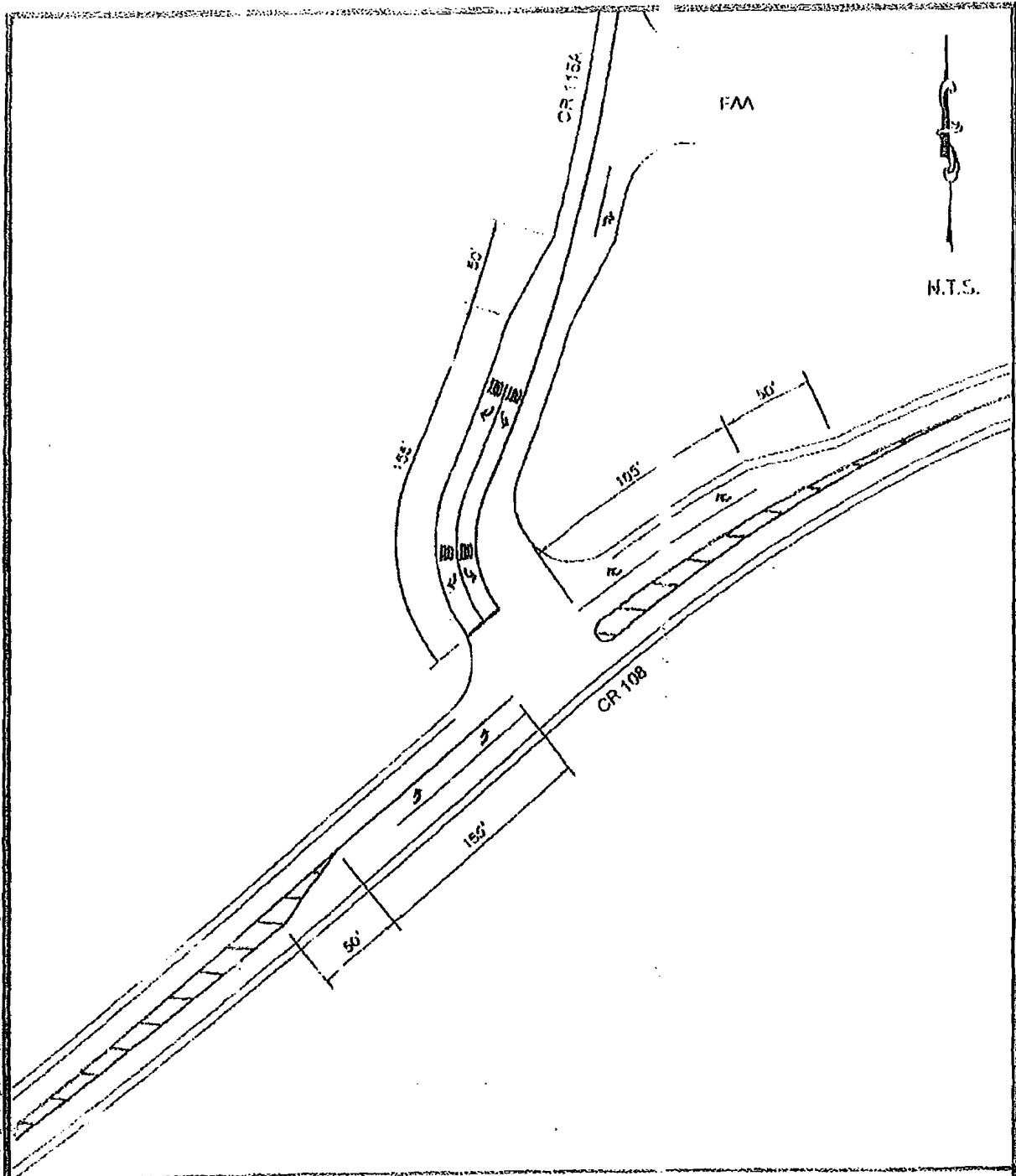

RECOMMENDED IMPROVEMENT PLAN

King
 ENGINEERING ASSOCIATES, P.A.
 6500 Highway 100, Suite 200
 Jacksonville, FL 32216
 Phone: 904.744.0000
 Fax: 904.744.0000
 www.king-engineering.com
 License No. 1000000000000000

CR 108 AT CR 115A
 NASSAU COUNTY IMPACT FEE STUDY
 NASSAU COUNTY, FLORIDA

Figure
 6

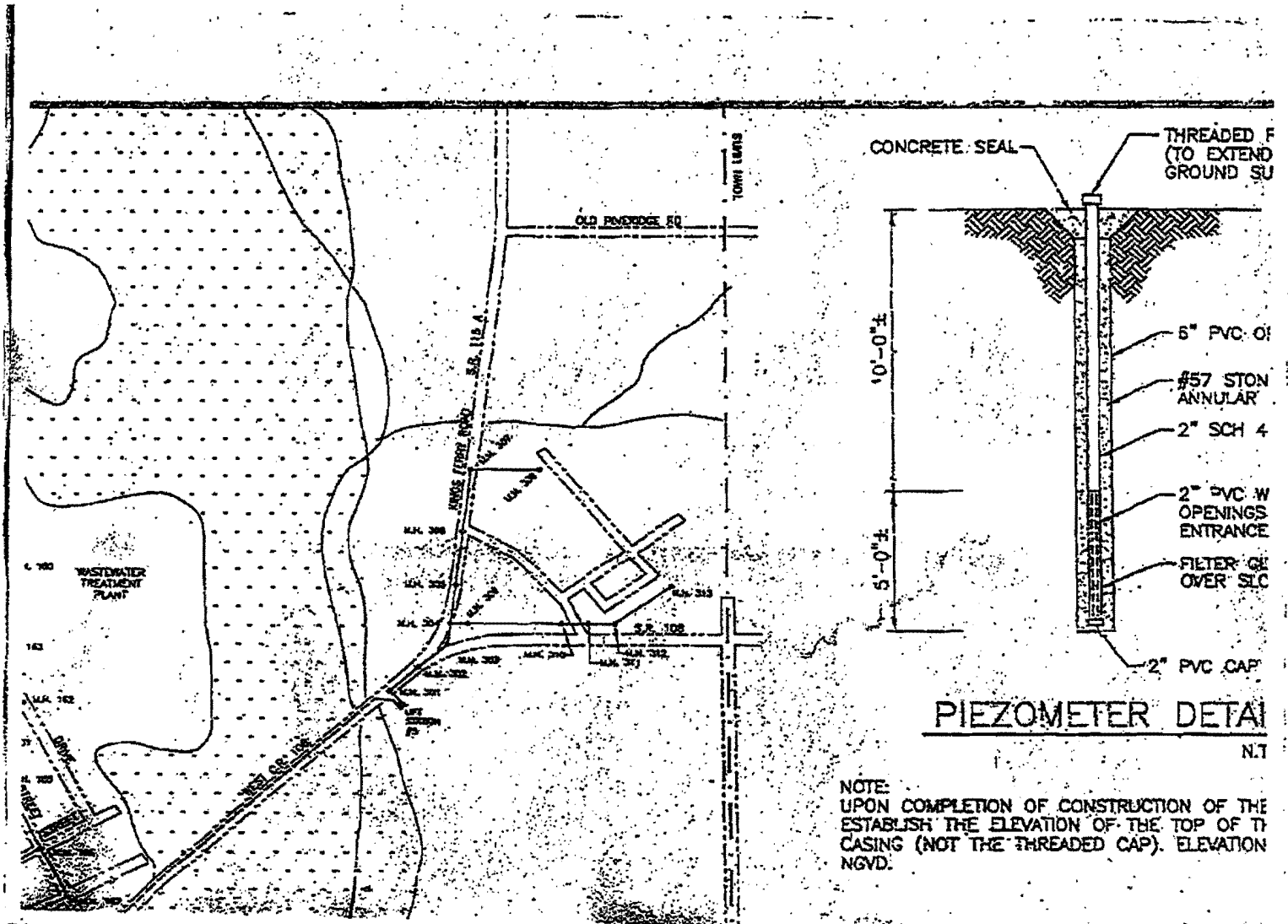

PIEZOMETER DETAIL

N.T

NOTE:
UPON COMPLETION OF CONSTRUCTION OF THE
ESTABLISH THE ELEVATION OF THE TOP OF THE
CASING (NOT THE THREADED CAP). ELEVATION
NGVD.

Existing Town of Hilliard water & sewer lines.
Provide by the Town of Hilliard 10/14/09



ESTIMATE OF WORK EFFORT AND FEE
CR 108 @ CR 115A

No. / ACTIVITY	Project Management			Engineer III		Engineer II		Designer		Clerical		Project Totals	
	Sheets	Man Hours	Labor Cost	Man Hours	Labor Cost	Man Hours	Labor Cost	Man Hours	Labor Cost	Man Hours	Labor Cost	Hours	Costs
TASK 1 - DATA COLLECTION													
1a Geotechnical													\$ 1,600.00
1b Survey / ROW Mapping													\$ 6,985.49
1c Traffic Data													\$ -
Subtotal													\$ 8,585.49
TASK 2 - PROJECT GENERAL TASKS													
2a-c Meetings	4	\$ 654.28	8	\$ 1,242.64	4	\$ 487.32	0	\$ -	4	\$ 220.16	20	\$ 2,604.40	
2d-e Project Administration	16	\$ 2,617.12	0	\$ -	0	\$ -	0	\$ -	40	\$ 2,201.80	56	\$ 4,818.72	
2f QA/QC	8	\$ 1,308.56	16	\$ 2,485.28	0	\$ -	0	\$ -	4	\$ 220.16	28	\$ 4,014.00	
Subtotal	28	\$ 4,579.96	24	\$ 3,727.92	4	\$ 487.32	0	\$ -	48	\$ 2,641.92	104	\$ 11,437.12	
TASK 3 - ROADWAY ANALYSES AND PLANS													
3a Field Review / Site Visit	4	\$ 654.28	4	\$ 621.32	8	\$ 974.64	8	\$ 737.60	0	\$ -	24	\$ 2,987.84	
3b Pavement Design	0	\$ -	0	\$ -	4	\$ 487.32	0	\$ -	0	\$ -	4	\$ 487.32	
3c Roadway Design Analysis	8	\$ 1,308.56	0	\$ -	40	\$ 4,873.20	24	\$ 2,212.80	0	\$ -	72	\$ 8,394.56	
3d Roadway Plans													
Key Sheet	1	\$ 0	0	\$ -	0	\$ -	2	\$ 184.40	0	\$ -	2	\$ 184.40	
Summary of Quantities	1	\$ 0	0	\$ -	2	\$ 243.66	8	\$ 737.60	0	\$ -	10	\$ 981.26	
Typical Sections Sheet	1	\$ 0	0	\$ -	4	\$ 487.32	4	\$ 368.80	0	\$ -	8	\$ 856.12	
General Notes	1	\$ 0	0	\$ -	3	\$ 365.49	2	\$ 184.40	0	\$ -	5	\$ 549.89	
Roadway Plans	6	\$ 981.42	0	\$ -	18	\$ 2,192.94	60	\$ 5,532.00	0	\$ -	84	\$ 8,706.36	
Special Details	1	\$ 0	0	\$ -	0	\$ -	0	\$ -	0	\$ -	0	\$ -	
Traffic Control Details	1	\$ 0	0	\$ -	8	\$ 974.64	16	\$ 1,475.20	0	\$ -	24	\$ 2,449.84	
Erosion Control Plans	6	\$ 0	0	\$ -	6	\$ 730.98	12	\$ 1,106.40	0	\$ -	18	\$ 1,837.38	
SWPPP and Erosion Control Detail Sheet	2	\$ 0	0	\$ -	2	\$ 243.66	2	\$ 184.40	0	\$ -	4	\$ 428.06	
Signing and Pavement Marking Sheet	6	\$ 0	0	\$ -	6	\$ 730.98	24	\$ 2,212.80	0	\$ -	30	\$ 2,943.78	
3e Design Documentation Report	2	\$ 327.14	0	\$ -	8	\$ 974.64	0	\$ -	16	\$ 880.64	26	\$ 2,182.42	
3f Pay Item Quantities	0	\$ -	0	\$ -	6	\$ 730.98	12	\$ 1,106.40	0	\$ -	18	\$ 1,837.38	
3g Specifications	2	\$ 327.14	0	\$ -	12	\$ 1,461.98	0	\$ -	24	\$ 1,320.96	38	\$ 3,110.06	
Subtotal	22	\$ 3,598.54	4	\$ 621.32	127	\$ 15,472.41	174	\$ 16,042.80	40	\$ 2,201.60	367	\$ 37,936.67	
TASK 4 - DRAINAGE ANALYSIS													
Subtotal	0	\$ -	35	\$ 5,436.55	0	\$ -	24	\$ 2,212.80	0	\$ -	59	\$ 7,649.35	
TASK 5 - UTILITY COORDINATION													
Subtotal	0	\$ -	20	\$ 3,106.60	0	\$ -	0	\$ -	8	\$ 440.32	28	\$ 3,546.92	
TASK 6 - SIGNALIZATION													
Subtotal	0	\$ -	0	\$ -	0	\$ -	0	\$ -	0	\$ -	0	\$ -	
TASK 7 - PERMITTING													
Subtotal	0	\$ -	24	\$ 3,727.92	8	\$ 974.64	0	\$ -	8	\$ 440.32	40	\$ 5,142.88	
TASK 8 - LIGHTING													
Subtotal	0	\$ -	0	\$ -	0	\$ -	0	\$ -	0	\$ -	0	\$ -	
TASK 9 - LANDSCAPE ARCHITECTURE													
Subtotal	0	\$ -	0	\$ -	0	\$ -	0	\$ -	0	\$ -	0	\$ -	
TASK 10 - ROW MAPPING													
Subtotal	0	\$ -	0	\$ -	0	\$ -	0	\$ -	0	\$ -	0	\$ -	
TASK 11 - CONSTRUCTION COST ESTIMATES													
Subtotal	2	\$ 327.14	0	\$ -	8	\$ 974.64	4	\$ 368.80	0	\$ -	14	\$ 1,670.58	
TASK 12 - BID PHASE SERVICES													
Subtotal	0	\$ -	0	\$ -	16	\$ 1,949.28	0	\$ -	16	\$ 880.64	32	\$ 2,829.92	
LUMP SUM TOTAL	52	\$ 8,505.64	107	\$ 16,620.31	183	\$ 19,858.29	202	\$ 18,624.40	120	\$ 6,604.80	644	\$ 78,798.93	
TASK 13 - POST DESIGN SERVICES													
Subtotal	8	\$ 1,308.56	0	\$ -	24	\$ 2,923.92	0	\$ -	16	\$ 880.64	48	\$ 5,113.12	
LIMITING AMOUNT TOTAL	8	\$ 1,308.56	0	\$ -	24	\$ 2,923.92	0	\$ -	16	\$ 880.64	48	\$ 5,113.12	
PROJECT TOTALS	60	\$9,814.20	107	\$16,620.31	187	\$22,782.21	202	\$18,624.40	136	\$7,485.44	692	\$83,912.05	

SURVEY ESTIMATION CHART

Consultant: CLARY & ASSOCIATES, INC.
 Name of Job: Nassau County Intersections
 Intersections: CR 108 at CR 115A
 Date: 10/26/2009
 County(ies) Nassau

SURVEY FUNCTIONS	CREW DAYS	SUBCON CREW DAYS	COMMENTS
Baseline Control			
Alignment			
Bench Levels			
Reference Points			
Section Line Ties			
Subdivision and Property Ties			
Side Street Surveys			
Topography	3.5		
Cross-Sections / Profiles			
Underground Utilities			
Special Surveys (ditches, canals, etc.)			
Stake Out for Borings			
Water Retention Area			
Supplemental Surveys			
Jurisdictional Line Surveys			
Aerial Targets			
TOTAL	3.5	0	

Survey T1hours 10 x \$150.00 3 Person Hourly Crew Rate = \$1,500.00 Day Rate

Survey Day Rate	<u>\$1,500.00</u>	x	<u>3.5</u>	=	<u>\$5,250.00</u>
Surveyor & Mapper	<u>\$173.21</u>	x	<u>0</u>	=	<u>\$0.00</u>
Cadd Tech/Computer Tech	<u>\$68.63</u>	x	<u>12</u>	=	<u>\$823.56</u>
Sr. Surveyor & Mapper	<u>\$214.47</u>	x	<u>4</u>	=	<u>\$857.88</u>
Secretary/Clerical	<u>\$54.05</u>	x	<u>1</u>	=	<u>\$54.05</u>
TOTAL SURVEY COST					<u>\$6,985.49</u>

Prepared by: Dennis Elswick

Date: October 26, 2009

Comments: _____

NASSAU COUNTY BOARD OF COUNTY COMMISSIONERS FINANCIAL ACTION FORM-IMPACT FEE USAGE JUSTIFICATION

Department: Engineering Services

Date: October 8, 2009

Subject: CR108 @ CR115A

FINANCIAL ACTION REQUESTED and Purpose (Attached Documentation if Necessary):

Request use of \$455,000.00 in Transportation Impact Fees from District 504 for the construction of turn lanes and associated roadway improvements. The attached Transportation Impact Fee Study is incorporated by reference herein. See Table 4 for a demonstration of capacity improvements. The requested amount represents 100% of the estimated construction costs as shown in Table 6. This segment is represented as Segment # 71A on the Transportation Analysis Spreadsheet.

IMPACT FUNDS AVAILABLE: \$ 837,444.79

ACCOUNT NUMBER for source of payment: 504 Transportation Impact Fees; specific project
account number to be established.

200K "4 TOT" TYPE
80K SB RIGHTWAY
70K WB " " "
105K EB LEFT " "
455K LBR
10/28/09

[Signature]
Department Head Signature **

[Signature]
Growth Management Signature **

[Signature]
Office of Management and Budget **

[Signature]
County Coordinator Signature **

10/8/09
Date

10/12/2009
Date

10/13/09
Date

10/13/09
Date

09 OCT 12 PM 12:03

** Reviewed and determined the accuracy of the underlying data
*** This item required for IMPACT FEE JUSTIFICATION or at the DIRECTION OF THE BOARD

COUNTY ATTORNEY action: APPROVED DISAPPROVE

Comments:
[Signature]
County Attorney Signature

10/16/09
Date

RECEIVED
2009 OCT 15 PM 2:49
COUNTY ATTORNEY

<p style="text-align: center;"><u>Clerk of Court/Comptroller Action</u></p> <p>APPROVED <input checked="" type="checkbox"/> DISAPPROVE <input type="checkbox"/></p> <p>Approved Amount \$ <u>455,000</u></p> <p><u>[Signature]</u> Clerk of Court/Comptroller Date <u>10/28/09</u></p>	<p style="text-align: center;"><u>Board of County Commissioners Action</u></p> <p>Final Approval <input checked="" type="checkbox"/> Disapproved <input type="checkbox"/></p> <p><u>[Signature]</u> Chairman, Board of Commissioners Date <u>11/9/09</u></p>
---	---

Office of the Clerk of Court
NASSAU COUNTY FLORIDA

NASSAU COUNTY BOARD OF COUNTY COMMISSIONERS
NOTES OF REGULAR SESSION, NOVEMBER 9, 2009

1. Approved Tabs A, D, E, F, G, I, J, K, L, and M.
2. Tab H - Deny the request and require the developer to keep the Maintenance Surety Bond for Amelia Concourse Subdivision, Phase I, in force as required by County Ordinance.
3. Engineering Services Department to research designating Daybreak Drive, Callahan area, as a golf cart road (by Ordinance); and contact Elizabeth Anno regarding same.
4. Approved to expend \$500.00 each from Districts 1 and 5 and \$300.00 each from Districts 2, 3, and 4 Discretionary Fund (Total of \$1,900.00) payable to the Callahan Athletic Association to assist the Pee Wee and Jr. Midget cheerleading squads with travel expenses to the Regional Competition on November 27, 2009 in Orlando Florida.
5. Expansion Item - Approved the priority ranking of three projects that might be eligible for American Recovery and Reinvestment Act (ARRA) Funding as follows: (1) Intersection of A1A and Blackrock Road estimated cost \$500,000.00; (2) Widen, Level and Overlay Pages Dairy Road from Chester Road to US 17 in the amount of \$700,000.00; and (3) Construction of sidewalk on Blackrock Road from Railroad tracks north to Heron Isles.
6. Expansion Item - Schedule public hearing for December 14, 2009 at 7:00 p.m. to adopt a Resolution Electing to Use the Uniform Method of Collecting Non Ad Valorem Special Assessments Within the Unincorporated and Incorporated Areas of Nassau.
7. Expansion Item - Approved and authorized the Chairman to sign the Settlement Agreement and Release of Claim and Stipulation for Dismissal in the case of Nassau County Board of County Commissioners, and John A. Crawford, in his capacity as Clerk of the Circuit Court for Nassau County, Florida, plaintiffs, vs. Estate of Jessica Julia Mixon, a/k/a Jessica J. Mixon, a/k/a Julia Jessica Mixion, a/k/a Jessica Julia Strickland Mixon, Case No. 05-386-CA, as executed by

the personal representative of the estate and his legal counsel.

8. Approved and authorized the Chairman to sign the following Financial Action Form - Impact Fee Usage Utilization for (1) Bryceville Ballpark Lighting in the amount of \$16,036.00 in District 505 Community Park Impact Fees for purchase and installation of field lights for two baseball fields, and (2) CR 108 at CR 115A in the amount of \$455,000.00 in District 504 Transportation Impact Fees for the construction of turn lanes and associated roadway improvements.
9. Commissioner Business - Request that Commissioners consider appointments to the Americans with Disabilities Act (ADA) Advisory Committee and bring back on November 18, 2009.
10. Commissioner Business - Approved authorization for the County Coordinator to have the County's IT Department add a link on the Nassau County website to the Sheriff's website.
11. Commissioner Business - Approved to appoint Commissioner Johnson to serve on the Strategic Action Group (SAG) for Vision 2032.
12. Commissioner Business - Commissioner Leeper to meet with the State Attorney's office (Wes White and Angela Corey) regarding enhancing the sexual predators ordinance. County Attorney to research piggybacking off an ordinance approved by St. Johns County regarding sexual predators.
13. Commissioner Business - Approved to waive the rental fees for the Greater Nassau County Chamber of Commerce to use the Callahan County Building for their quarterly meetings.
14. Commissioner Business - Approved to waive the rental fees for the Jones Cemetery Association, Inc., to use the Callahan County Building for their Annual and Board meetings (maximum of six meetings per year).
15. Approved to confirm and clarify the authority of the County Coordinator to handle employee separations as he deems appropriate, including offering a severance package reflecting the existing budgeted salary and requesting that the employee sign a release in exchange for a severance package.